

Multi Mono Specialised

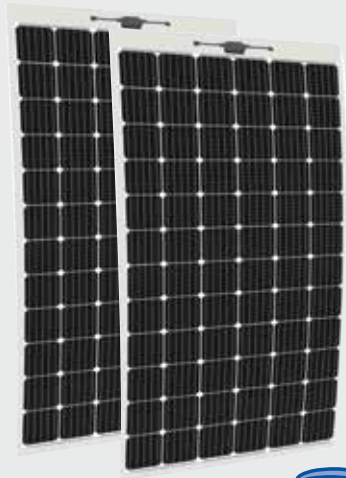

DERV®

*Module images for representation purpose only

Solar PV Module

DERV Semi-Rigid PV Modules MSR, SSR

MSR: 300 Wp - 330 Wp

SSR: 325 Wp - 370 Wp

The ideal PV Module for all applications that use the highest quality of PV Cells, in-house Encapsulants, and Backsheets.

MSR is the series of Multi Crystalline Semi-Rigid Solar PV Modules, available in Multi Crystalline and Mono Crystalline PV Cells with 50% of the conventional weight (11 Kg).

SSR is the series of Mono Crystalline Semi-Rigid Solar PV Modules, available in Multi Crystalline and Mono Crystalline PV Cells with 50% of the conventional weight (11 Kg).



SAFE



IP67 Junction box



5 years of product warranty



10 Years of limited power output warranty



1000 Vdc



RELIABLE



Extreme weather resilience



Suitable for all roof types



Colour options available



HIGH PERFORMANCE



PID resistant



Superlative performance in low light



High power density



Positive power tolerance

Ideal for:



Residential



Commercial



Utility



Off-grid

Certifications:

- IEC Compliant
- Independently audited by SOLARBUYER
- IMS Certified Company - ISO 9001: 2015 & OHSAS 45001: 2018
- EMS - ISO 14001: 2015



RenewSys is the first integrated manufacturer of Solar PV Modules and its key components- Encapsulants (EVA and POE), Backsheets and Solar PV Cells. We have a global presence with offices in India, Mauritius, Nigeria, South Africa, Singapore, UAE, China, representatives in Brazil, Europe, USA, Mexico, and an evolving distributor network.

Registered Office

Unit No. 607, 6th Floor, Trade Center, Bandra-Kurla Complex, Bandra East, Mumbai - 400 051, Maharashtra, India

Factory

Plot No.6, Survey # 114/P, Srinagar Village, Maheshwaram Mandal, Dist - Rangareddy, Hyderabad - 501 359, Telangana, India

- Please refer to the installation manual for detailed information.

Performance under standard test conditions (1000w/m², AM 1.5, 25 °C)

	MSR (315 Wp - 330 Wp)	SSR (345 Wp - 370 Wp)
DESERV (Wp)	330	370
Rated power (Pmax), Wp	330	370
Max. power voltage (Vmp), V	37.67	39.94
Max. power current (Imp), A	08.77	09.27
Open circuit voltage (Voc), V	46.24	49.12
Short circuit current (Isc), A	09.26	09.79
Module efficiency (%)	16.66	18.68
NOCT (Wp) at 45 ± 2 °C @800 W/m²	330	370
Pmax (W)	245.60	275.37
Max. power voltage (Vmp), V	34.45	36.53
Max. power current (Imp), A	07.14	07.55
Open circuit voltage (Voc), V	43.00	45.67
Short circuit current (Isc), A	07.56	08.00

Mechanical Characteristics	
Cable	No. 12 AWG, 4mm ²
PV Connectors	MC4 Connectors / MC4 Compatible
Junction box	IP67 Junction box with 4 rail/split junction box with 3 bypass diodes

Operating Conditions	
Ambient temperature, °C	-40 to +85
Max. system voltage, Vdc	1000

Cell Temperature Coefficient	MSR	SSR
Open circuit voltage	-0.30 % / °C	-0.28 % / °C
Short circuit current	+0.05 % / °C	+0.048 % / °C
Nominal power	-0.40 % / °C	-0.36 % / °C

Physical Parameters	
No. of cells	72
Module dimension (mm)	2010 X 985 (± 2)
Module thickness (mm)	3.5
Approximate weight (kg)	11

Module Dimension Diagram (mm)

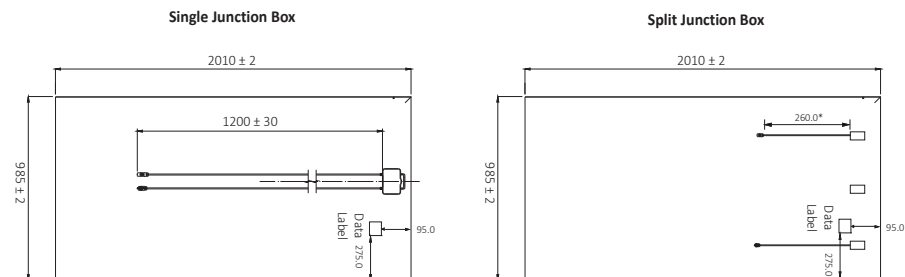

*Due to continuous product updation, specifications may change without notice.
Kindly refer to the website for latest information: www.renewsysworld.com